



AQUIND Limited

AQUIND INTERCONNECTOR

**Compulsory Aquisition Hearing 1 – Appendix 1
- Exhibit 1 Image Showing Car Parking
Spaces in Work No.3 Areas**

The Planning Act 2008

Infrastructure Planning (Examination Procedure) Rules 2010, Rule 8(c)

Document Ref: 7.9.18.1

PINS Ref.: EN020022

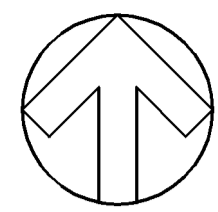

**TEMPORARY CAR PARK: UP TO 206 PARKING BAYS,
14 LGV PARKING BAYS & 7 HGV PARKING BAYS**

CONTRACTOR TO SIZE DRAINAGE NETWORK FOR A 1 IN 30 YEAR RETURN PERIOD WITH ZERO PERCENT CLIMATE CHANGE. APPROXIMATE STORAGE REQUIRED FOR 1:30 YEAR EVENT AT 1.4L/S DISCHARGE IS 335m³ TO 508m³.

CONTRACTOR'S COMPOUND IS NOT INTENDED FOR POLLUTANTS AND THEREFORE IS PROPOSED FOR A PERMEABLE SURFACE ALLOWING SURFACE WATER INFILTRATION DIRECT TO THE GROUND. ANY POTENTIALLY POLLUTING ACTIVITIES INCLUDING DIESEL GENERATORS WILL BE SUBJECT TO POLLUTION PREVENTION CONTROLS AND DETAILED DRAINAGE DESIGN BY THE CONTRACTOR TO MEET THE WATER QUALITY TREATMENT AND FLOW RESTRICTION PRINCIPLES OF THE OPERATIONAL PHASE. AN INDICATIVE CONNECTION IS ILLUSTRATED IN THE SOUTH WESTERN CORNER.

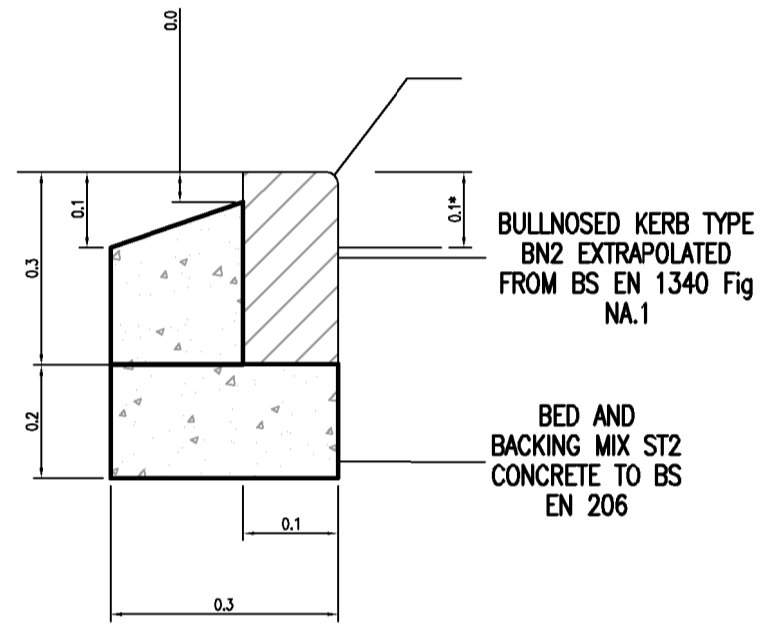
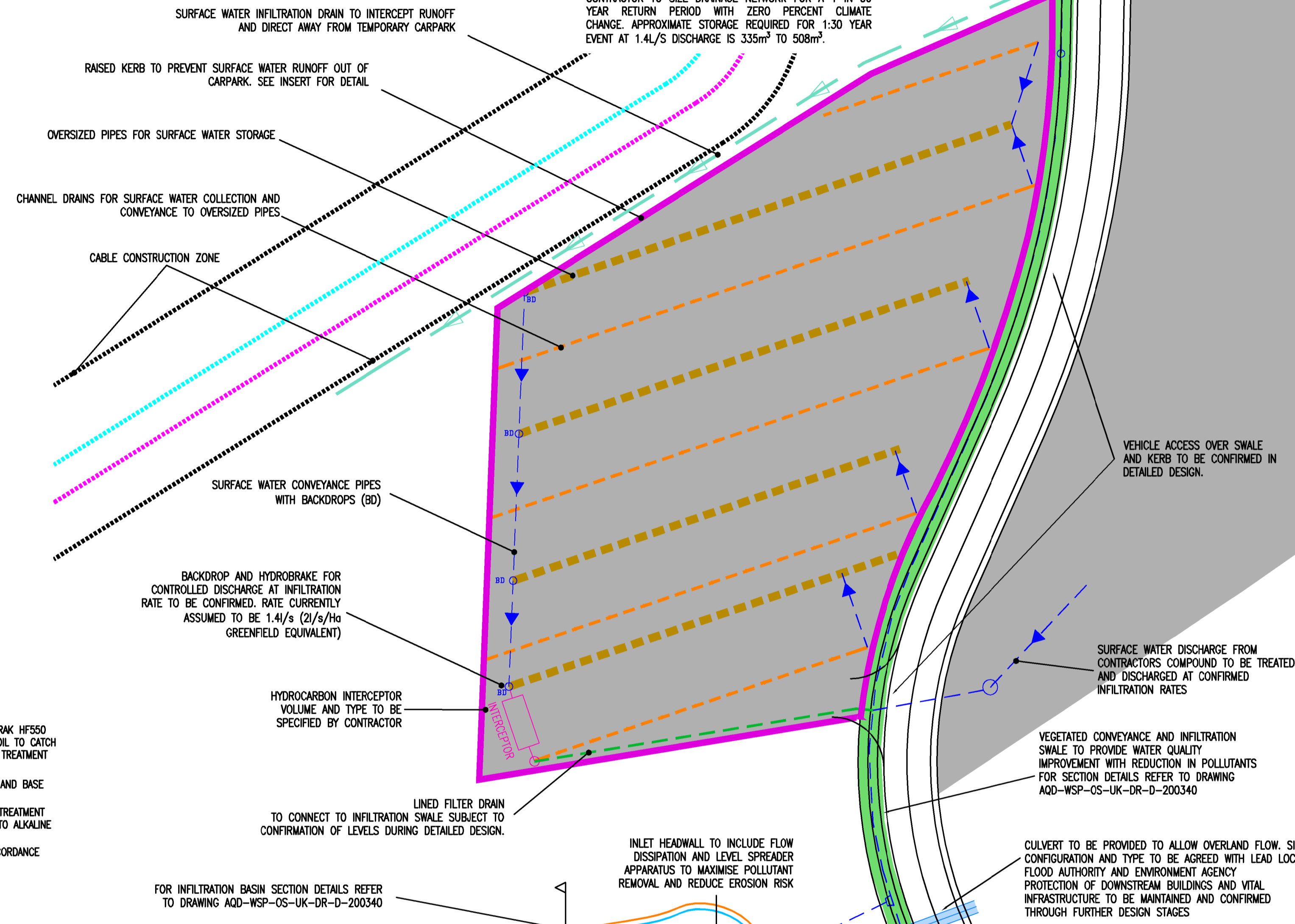

TYPICAL BN2 TYPE KERB
1:10 SCALE
(*UPSTAND HEIGHT IS SUBJECT TO CHANGE)

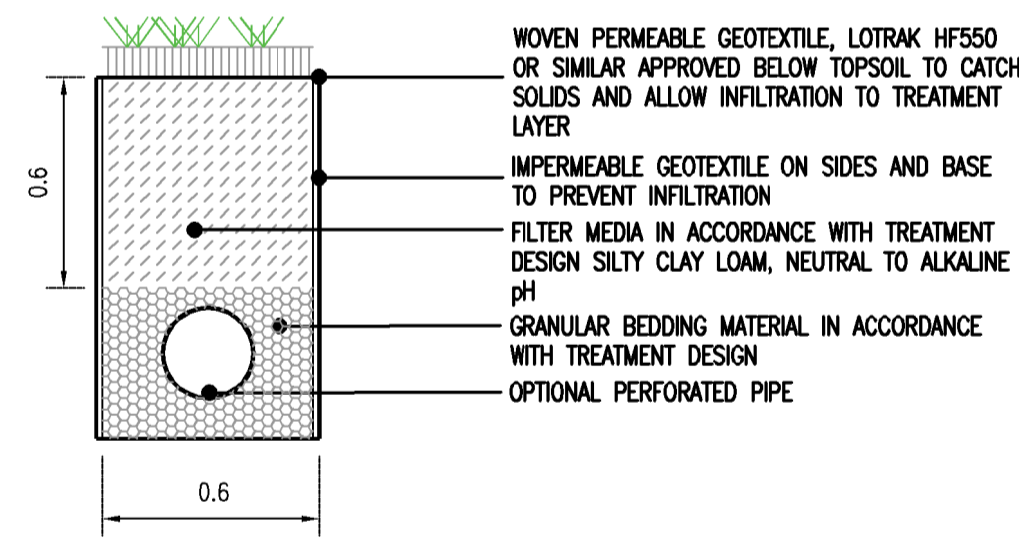

TYPICAL SEALED FILTER DRAIN
SCALE 1:10

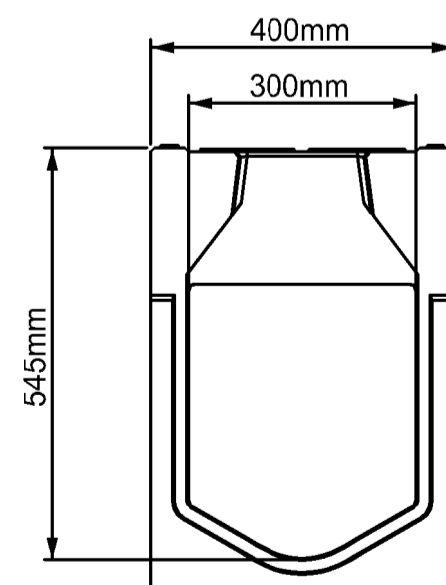

TYPICAL ACO CHANNEL DRAIN H
RANGE RD300
1:10

BACKDROP AND HYDROBRAKE FOR CONTROLLED DISCHARGE AT INFILTRATION RATE TO BE CONFIRMED. RATE CURRENTLY ASSUMED TO BE 1.4l/s (2l/s/Ha GREENFIELD EQUIVALENT)

HYDROCARBON INTERCEPTOR VOLUME AND TYPE TO BE SPECIFIED BY CONTRACTOR

LINED FILTER DRAIN TO CONNECT TO INFILTRATION SWALE SUBJECT TO CONFIRMATION OF LEVELS DURING DETAILED DESIGN.

FOR INFILTRATION BASIN SECTION DETAILS REFER TO DRAWING AQD-WSP-GS-UK-DR-D-200340

INLET HEADWALL TO INCLUDE FLOW DISSIPATION AND LEVEL SPREADER APPARATUS TO MAXIMISE POLLUTANT REMOVAL AND REDUCE EROSION RISK

SURFACE WATER DISCHARGE FROM CONTRACTORS COMPOUND TO BE TREATED AND DISCHARGED AT CONFIRMED INFILTRATION RATES

VEGETATED CONVEYANCE AND INFILTRATION SWALE TO PROVIDE WATER QUALITY IMPROVEMENT WITH REDUCTION IN POLLUTANTS FOR SECTION DETAILS REFER TO DRAWING AQD-WSP-GS-UK-DR-D-200340

CULVERT TO BE PROVIDED TO ALLOW OVERLAND FLOW. SIZE, CONFIGURATION AND TYPE TO BE AGREED WITH LEAD LOCAL FLOOD AUTHORITY AND ENVIRONMENT AGENCY PROTECTION OF DOWNSTREAM BUILDINGS AND VITAL INFRASTRUCTURE TO BE MAINTAINED AND CONFIRMED THROUGH FURTHER DESIGN STAGES

WATER SAMPLING STATIONS TO BE PROVIDED IN ACCORDANCE WITH THE REGULATORY AUTHORITIES REQUIREMENTS

VEGETATED INFILTRATION BASIN TO PROVIDE WATER QUALITY IMPROVEMENT WITH REDUCTION IN POLLUTANTS

APPROXIMATE DETENTION BASIN VOLUME = 2300m³

TOP OF DETENTION BASIN LEVEL = 65.90M
100 YEAR STORM WATER LEVEL (+40% CLIMATE CHANGE) = 65.60M
BASE OF DETENTION BASIN LEVEL = 63.90M

INFILTRATION BASIN SIZE, CONFIGURATION AND DETAIL IS INDICATIVE ONLY AT THIS STAGE AND IS SUBJECT TO RECEIPT OF INFILTRATION RATES, CONSULTATION WITH PROJECT ECOLOGIST & LANDSCAPE ARCHITECT AND AGREEMENT OF DRAINAGE STRATEGY WITH LOCAL WATER AUTHORITY, LEAD LOCAL FLOOD AUTHORITY AND THE ENVIRONMENT AGENCY

NOTE:
ALL DETAILS SHOWN ARE INDICATIVE AND SUBJECT TO FINAL DESIGN BY THE CONTRACTOR

REV	DATE	BY	DESCRIPTION	CHK	APP
P02	23/09/2020	JM	ADDITION OF ACO CHANNEL DRAIN CONSTRUCTION DETAIL AND REVISED LAYOUT		
P01	04/08/2020	KR	FIRST ISSUE		

DRAWING STATUS: FOR INFORMATION

WSP House, 70 Chancery Lane, London, WC2A 1AF, UK
T+ 44 (0) 207 314 5000, F+ 44 (0) 207 314 5111
wsp.com

PROJECT: AQUIND Interconnector

TITLE: INDICATIVE TEMPORARY CARPARK AND COMPOUND DRAINAGE LAYOUT

SCALE AT:	CHECKED:	APPROVED:
1:500	NM / HM	MM
PROJECT No:	DESIGNED:	DRAWN:
62100616	KR	KR
DRAWING No:	DATE:	REV:
AQ-ITT-UK-LAY-101	04/08/2020	P01

© WSP UK Ltd

Reproduced from Ordnance Survey digital map data © Crown copyright 2018. All rights reserved. Licence number 0100031673.
© Crown copyright material is reproduced with the permission of Land Registry under delegated authority from the Controller of HMSO. This material was last updated in 2018 and may not be copied, distributed, sold or published without the formal permission of Land Registry. Only an official copy of a title plan or register obtained from the Land Registry may be used for legal or other official purposes. May contain public sector information licensed under the Open Government Licence v 3.0.

